

LOCATED IN THE WEST 1/2 SECTION 4
TOWN 1 NORTH, RANGE 17 EAST
WALWORTH COUNTY, WISCONSIN

Parcel 2: Ingress and Egress Easement as recorded on August 14, 1984 in Volume 329 of Records on page 230 as Document No. 106093.

Tax Key No. 1A 2200002

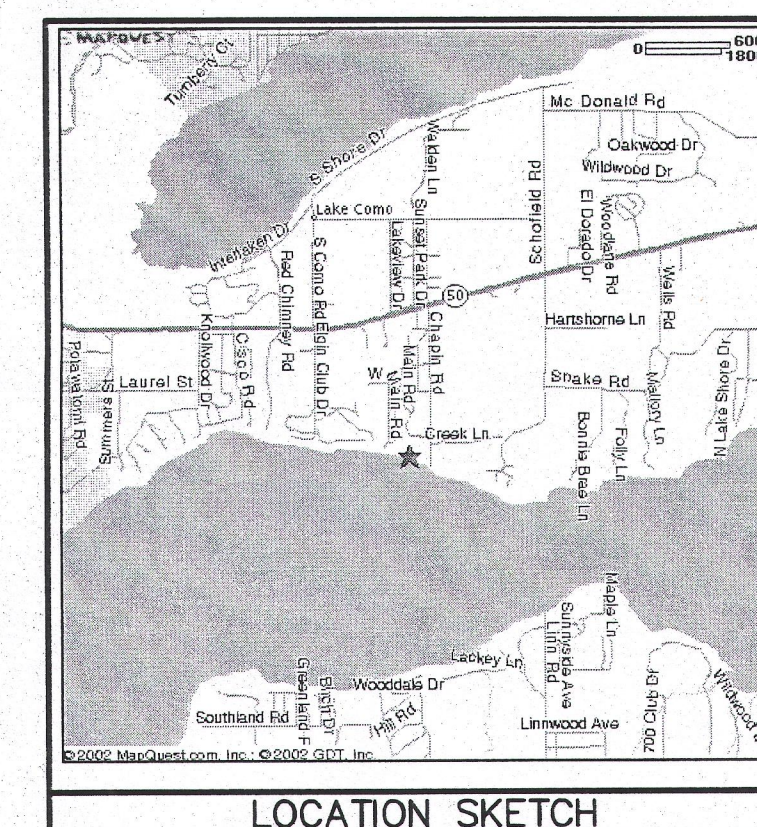

1.) EASEMENT RECORDED AS DOCUMENT NO. 541508, GRANTS THE GAS COMPANY THE RIGHT TO CONSTRUCT AND MAINTAIN A GAS LINE AND ALL APPURTENANT STRUCTURES ON THE LANDS SURVEYED. THERE IS NO SPECIFIC LOCATION OR WIDTH TO THIS EASEMENT.

4.) GARAGE ENCROACHMENT ONTO PARCEL C IS ALLOWED PER EASEMENT RECORDED AS DOC. NO. 0481773.

NOTE: COPIES OF THIS MAP TO WHICH THE FOLLOWING CERTIFICATE WILL APPLY SHOW SURVEYOR'S ORIGINAL SEAL AND SIGNATURE IN RED INK. COPIES BY ANY OTHER MEANS MAY HAVE ALTERATIONS WHICH DO NOT REPRESENT THE SURVEYOR'S WORK PRODUCT.

I HEREBY CERTIFY THAT THE ABOVE DESCRIBED PROPERTY HAS BEEN SURVEYED UNDER MY DIRECTION AND THAT THE ABOVE MAP IS A TRUE REPRESENTATION THEREOF AND SHOWS THE SIZE AND LOCATION OF THE PROPERTY, ITS EXTERIOR BOUNDARIES, THE LOCATION OF ALL SITES, STRUCTURES, AND DIMENSIONS OF ALL PRINCIPAL BUILDINGS THEREON, BOUNDARY FENCES, APPARENT EASEMENTS, ROADWAYS, AND VISIBLE ENCROACHMENTS, IF ANY. THIS SURVEY IS MADE FOR THE USE OF THE PRESENT OWNERS OF THE PROPERTY, AND ALSO THOSE WHO PURCHASE, MORTGAGE, OR GUARANTEE THE TITLE THERETO WITHIN ONE YEAR FROM THE DATE HEREOF.

DATED: APRIL 27, 2015

REVISED 05-04-2015
TO SHOW OWNERSHIP OF LAKE ACCESS STRIP
BEING OWNED BY PARCEL B

PETER S. GORDON R.L.S. 2101



STRIP

WISCONSIN
 PETER S. GORDON
 S-2101
 ELKHORN, WI
 LAND SURVEYOR

FARRIS, HANSEN & ASSOCIATES, INC.
ENGINEERING - ARCHITECTURE - SURVEYING
7 RIDGWAY COURT P.O. BOX 437
ELKHORN, WISCONSIN 53121

REVISIONS
02/25/2003 ADD VACATED NOTE

11/19/2003
TO SHOW SIZE &
LOCATION OF
PROPOSED RESIDENCE

PROJECT NO.
6168

DATE 12-13-02

SHEET NO.
1 OF 1

MAY 04 2015

5/4/2015 X: \Projects\6168\SURVEY2015

IA 22-2 117-3805